

**HiB**

MAKING  
**BATHROOMS**  
BEAUTIFUL

**Technical Drawing &  
FAQ Data Sheets**

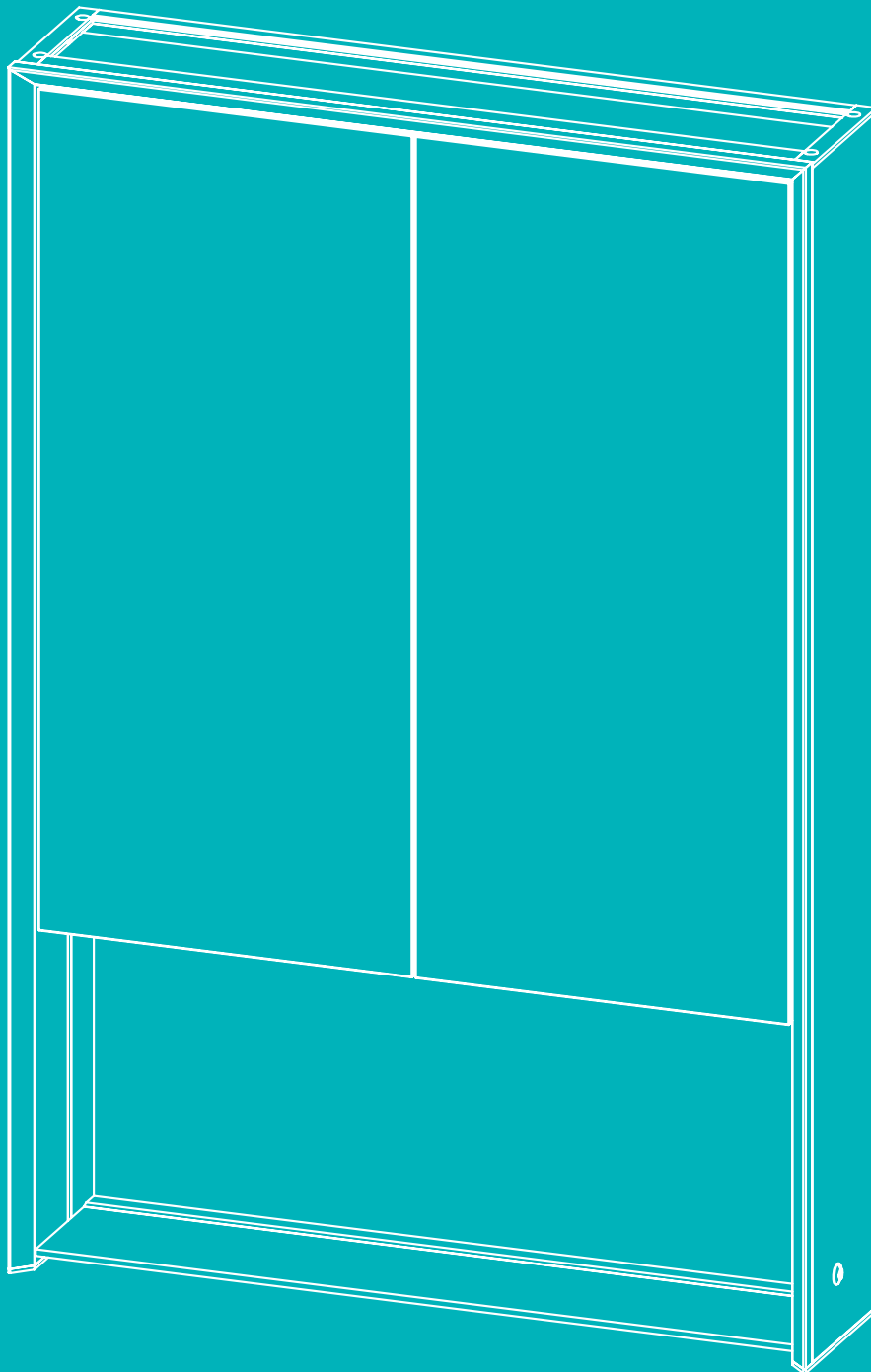

**Verve 50**

**Verve 60**

**Verve 80**

HiB recommend you receive the product before commencing with installation as all sizes and measurements are approximate.  
 HiB try and ensure all measurements are as accurate as possible.  
 In the interest of continuous product development, HiB reserves the right to alter specification as necessary. E & OE.

## Verve 50

Art no. 52700

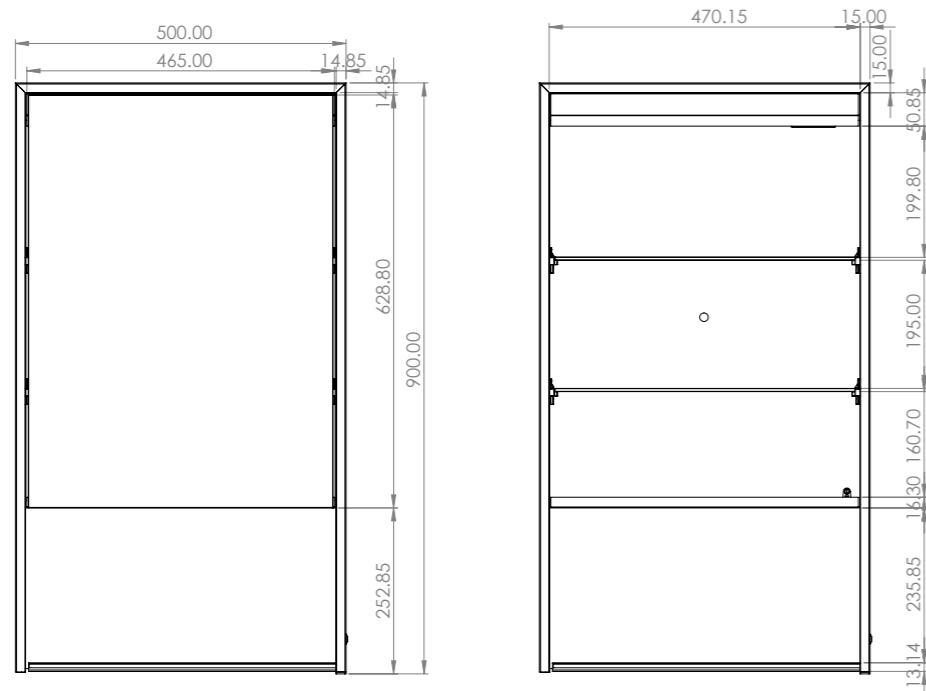

HiB recommend you receive the product before commencing with installation as all sizes and measurements are approximate.  
 HiB try and ensure all measurements are as accurate as possible.  
 In the interest of continuous product development, HiB reserves the right to alter specification as necessary. E & OE.

## Verve 80

Art no. 52900

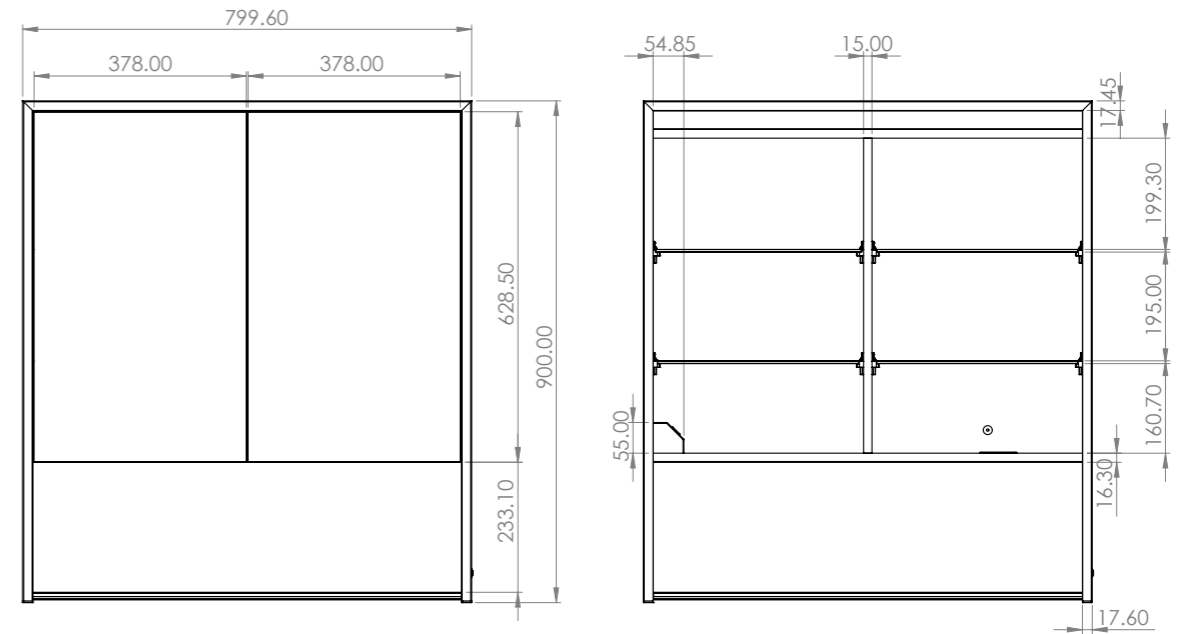

## Verve 60

Art no. 52800

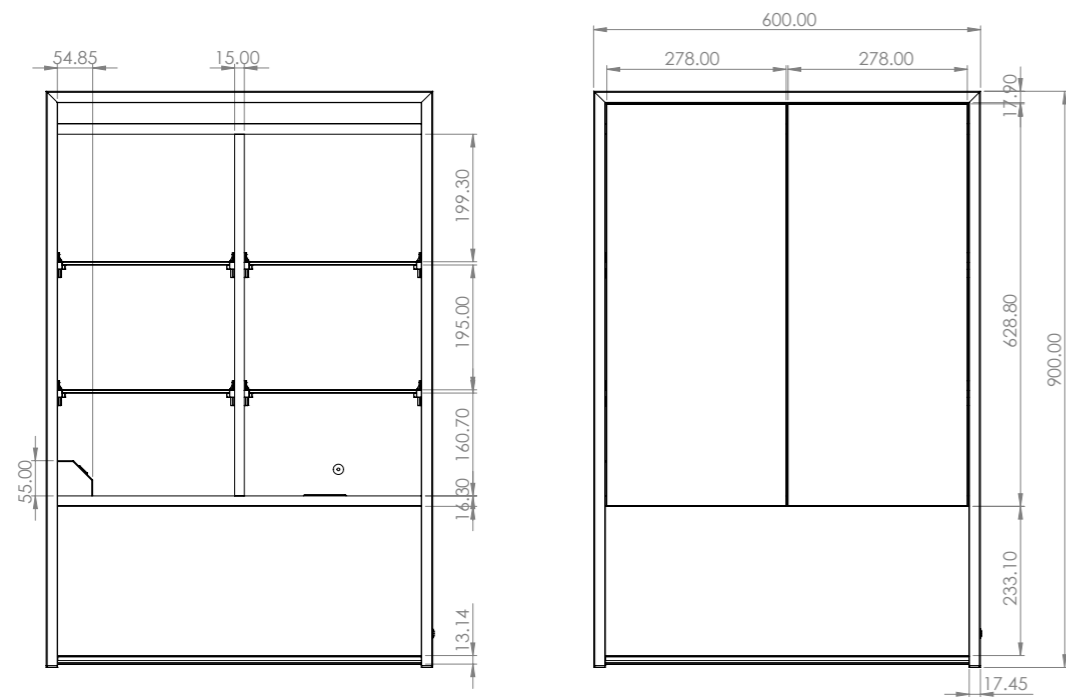

### Electrical Safety Information

HiB recommends that all electrical bathroom products should only be fitted by a suitably qualified, Part P registered electrician in accordance with current IEE regulations.

Ensure mains power supply is switched off before starting installation.  
 Before drilling, ensure there are no hidden cables or pipes in the wall.

### Electrical Safety Information

HiB recommends that all electrical bathroom products should only be fitted by a suitably qualified, Part P registered electrician in accordance with current IEE regulations.

Ensure mains power supply is switched off before starting installation.  
 Before drilling, ensure there are no hidden cables or pipes in the wall.

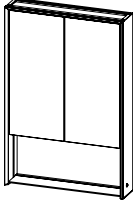
		Version No. 10.12.19
	Product	Verve 50, Verve 60 & Verve 80
	Art. No.	Verve 50: 52700 / Verve 60: 52800 / Verve 80: 52900
	Product Description	Illuminated mirror cabinet.

Question	Answer
Nett weight (kg)	Verve 50: 18kg / Verve 60: 21kg / Verve 80: 25kg
Light Source	LED
Light Source Average Lifespan	Average: 26,280hr
Total Rated Wattage (W)	Verve 50: 47.5w / Verve 60: 49.4w / Verve 80: 53.3w
Lumens (Lm)	Verve 50: 2200lm / Verve 60: 2380lm / Verve 80: 2600lm
Kelvins (k)	Verve 50, 60 & 80: 6000k
Is the mirror dimmable?	No
Energy Rating	A Class
What orientation can the mirror be hung in?	All Verve mirrors are hung portrait
Is the heated pad only on when the mirror is illuminated?	Yes
Does the mirror require an earth connection?	No
Can I bypass the sensor so the mirror comes on with the main room light?	No
Is it cool white or warm white illumination?	Cool White
How long is the warranty?	5 years from date of purchase on silvering coating on mirror 2 years from date of purchase on electrical components in the mirror

### Electrical Safety Information

HiB recommends that all electrical bathroom products should only be fitted by a suitably qualified, Part P registered electrician in accordance with current IEE regulations.

Ensure mains power supply is switched off before starting installation.

Before drilling, ensure there are no hidden cables or pipes in the wall.

**HiB recommend you receive the product before commencing with installation as all sizes and measurements are approximate.**

**HiB try and ensure all measurements are as accurate as possible.**

**In the interest of continuous product development, HiB reserves the right to alter specification as necessary. E & OE.**