

## LAUFEN PRO

### WC seat and cover, removable, with lowering system, stainless steel hinges



#### DIMENSIONS

Length	370 mm
Width	450 mm
Height	55 mm

#### COLOUR AND FINISH

300 White

#### OPTIONS

000 - standard option

#### SPECIFICATION TEXT

WC seat and cover LAUFEN PRO, Duroplast hollow space fixation, removable, automatic lowering system matching floorstanding WC pan, order no. 82295.2 and wallhung WC pan, order no. 82095.6, 82096.5, 82096.6 Order no. 89695.1

Hinge material : Stainless steel

Quick release

Soft close system

Net weight (kg) : 1.9

Shape : Round

#### TECHNICAL DRAWINGS

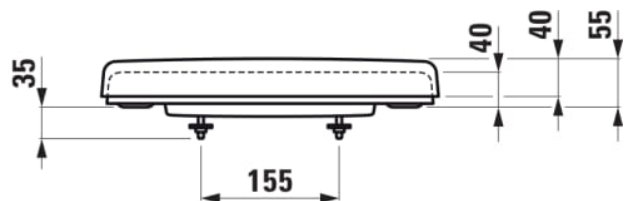
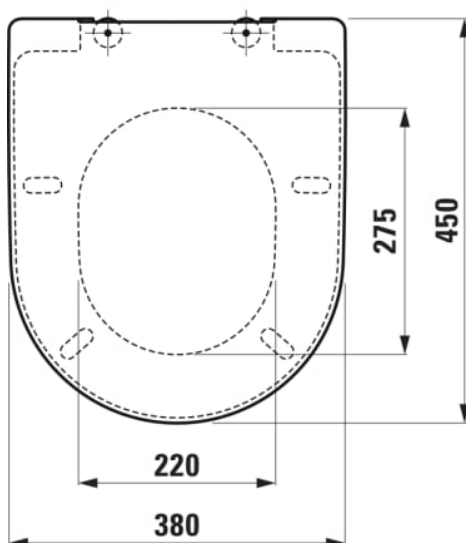

COMPATIBLE WITH



Wall-hung WC  
'rimless/compact',  
washdown, without flushing  
rim

**H820965...0001**



Wall-hung WC 'rimless',  
washdown, with niches,  
without flushing rim

**H820964...0001**



Wall-hung WC 'rimless',  
washdown

**H820966...0001**



Floorstanding WC,  
washdown, with flushing  
rim, outlet  
horizontal/vertical

**H822952...0001**



Floorstanding WC 'rimless',  
washdown, without flushing  
rim, outlet  
horizontal/vertical

**H822956...0001**

Floorstanding WC close-  
coupled, washdown,  
rimless, outlet horizontal or  
vertical; Open back, Vario  
Outlet, vertical 70- 250,  
optimized for 4.5/3l  
flushing

**H8259640000001**

Floorstanding WC close-  
coupled, washdown,  
rimless, outlet horizontal or  
vertical; Open back, Vario  
Outlet, vertical 70- 250,  
optimized for 4.5/3l  
flushing

**H8259644000001**



Floorstanding WC, close-  
coupled, washdown,  
rimless, outlet horizontal or  
vertical

**H825962...0001**



Floorstanding WC, close-  
coupled, washdown,  
rimless, outlet horizontal or  
vertical

**H825962...2311**



Floorstanding WC, close-  
coupled, washdown, with  
flushing rim, outlet  
horizontal/vertical

**H825952...0001**



Floorstanding WC, close-  
coupled, washdown, with  
flushing rim, outlet  
horizontal/vertical

**H825952...2311**



## LAUFEN PRO

LAUFEN pro is a comprehensive bathroom range, which offers the ideal solution for every spatial situation and requirement and also reflects the building values of the current generation. Industrial design is the modern answer to the once revolutionary idea that everyone has a right to enjoy beautiful forms. Good design is now no longer a right reserved for the most affluent customers. Modern methods of industrial production and designers such as Peter Wirz of Vetica, who put optimum manufacturing feasibility at the forefront of their creative processes, make such sanitary ware ranges as LAUFEN pro possible. This does not just benefit the designer, more importantly, it also benefits the customer.

