

LAUFEN PRO

Wall-hung WC, washdown, with flushing rim (anchor screw spacing 180 mm)



DIMENSIONS

Length	560 mm
Width	360 mm
Height	350 mm

COLOUR AND FINISH

000 White

OPTIONS

000 - standard option

SPECIFICATION TEXT

Wall-hung WC pan washdown LAUFEN PRO, sanitary ceramic, for concealed cistern, EN 997, EN 33, 6/5-l-flush, dimensions 360 x 560 x 350 mm, Special feature: concealed surfaces directing water are fully glazed, throughout, vacuum checked, Further options / accessories: Surface refinement LCC (only white), WC seat 89295.0, 89395.4, WC seat and cover, 89195.0, 89295.1, 89395.2, WC seat and cover with automatic lowering 89195.1, 89395.3, Order no. 82095.0

Cistern type : Concealed

Flushing system : Washdown

Installation type : Wall-hung

Net weight (kg) : 18.4

Outlet type : Horizontal

Rim type : Open

Shape : Round

Style : Neutral

Water Inlet System : Back Inlet

TECHNICAL DRAWINGS

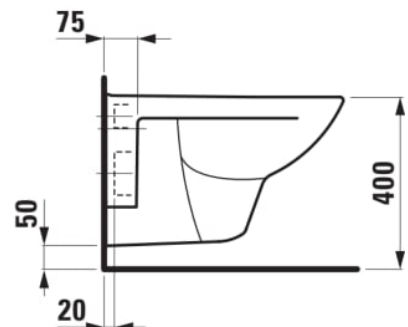
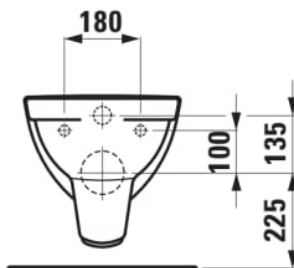
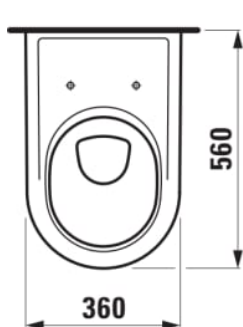

COMPATIBLE WITH



WC seat and cover

H892951...0001



WC seat and cover
'universal', removable

H893952...0001



WC seat and cover
'universal', removable, with
lowering system

H893958...0001



WC seat and cover, 'slim'

H8989600...001

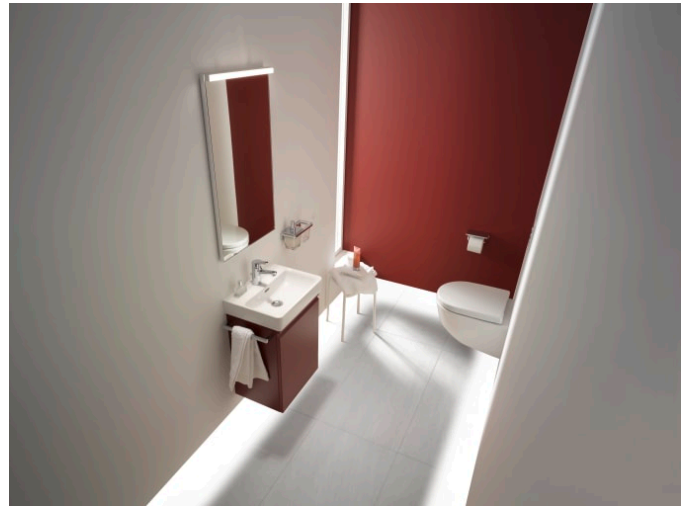



LAUFEN PRO

LAUFEN pro is a comprehensive bathroom range, which offers the ideal solution for every spatial situation and requirement and also reflects the building values of the current generation. Industrial design is the modern answer to the once revolutionary idea that everyone has a right to enjoy beautiful forms. Good design is now no longer a right reserved for the most affluent customers. Modern methods of industrial production and designers such as Peter Wirz of Vetica, who put optimum manufacturing feasibility at the forefront of their creative processes, make such sanitary ware ranges as LAUFEN pro possible. This does not just benefit the designer, more importantly, it also benefits the customer.

